

REV.	DESCRIPTION	DATE	DRAWN
A	NEW	14.03.2013	Ronny

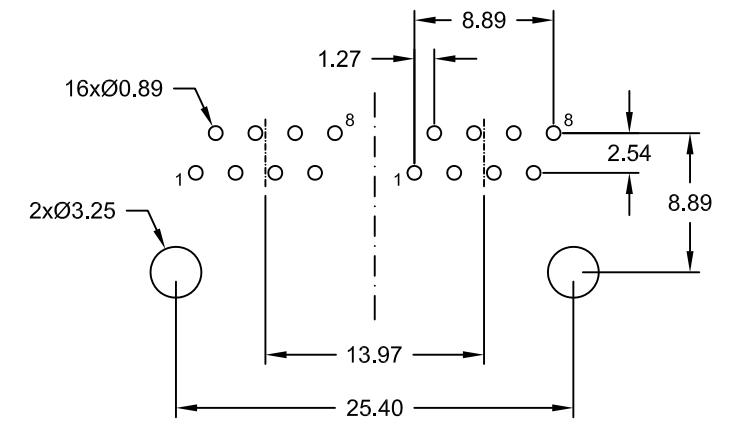

Recommended PCB Layout  
Top View  
(Tolerance ±0.05)

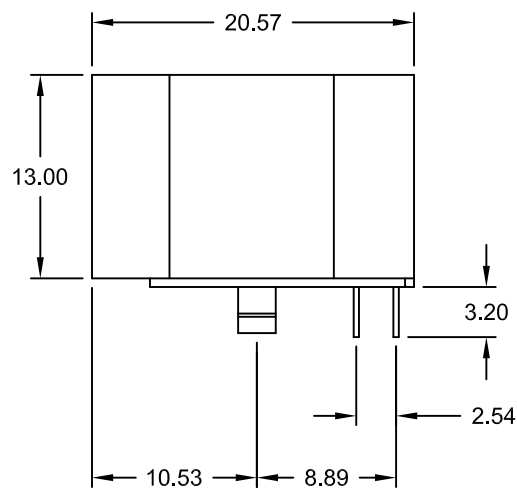
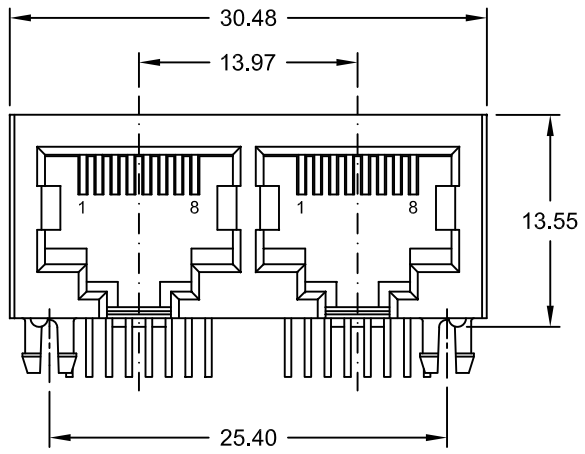
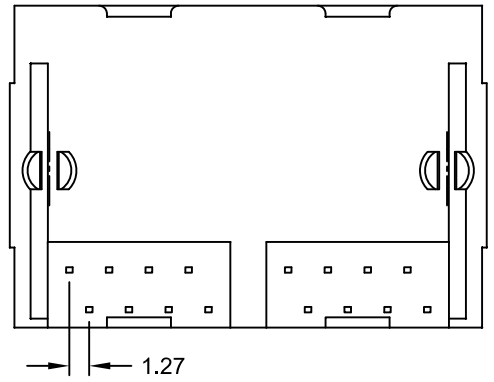

### Specifications

- Current rating: 1.5A
- Insulation resistance: 500MΩ min. / 500V DC
- Withstanding voltage: 1000V AC rms 60Hz / Minute
- Contact resistance: 40mΩ max.
- Operating temperature: -40°C to +85°C

### Materials

- Contact: Phosphor Bronze
- Plating: Sn on solder, Au on contact area; Ni under plated
- Insulator: PBT UL 94V-0

PART NUMBER	GOLD PLATING CONTACT AREA
MJS-288-D1L0-95	3μ"
MJS-288-D1L0-96	6μ"
MJS-288-D1L0-97	15μ"
MJS-288-D1L0-98	30μ"
MJS-288-D1L0-9H	50μ"



UNIT	GENERAL TOLERANCE	DRAWN	DATE	DWG. NO.	SHEET 1/1
mm	X.° ± X ± 0.50	Ronny	14.03.2013	2311501	REV. A
SCALE	.X° ± .X ± 0.38	Hogi	14.03.2013	SERIES NO.	
	.XX° ± .XX ± 0.25	Hogi	14.03.2013	MJS-288-D1L0-9x	
	Ang. ± 3° .XXX ± 0.10				

**Multi Port "side by side" RJ 45 PCB JACK**  
**2 x <8P8C> "TAB DOWN"**  
 SIDE ENTRY LONG PROFILE TYPE  
**NON SHIELDED**