

female

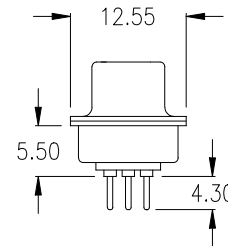
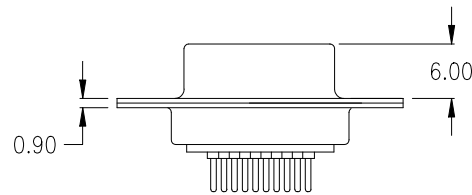
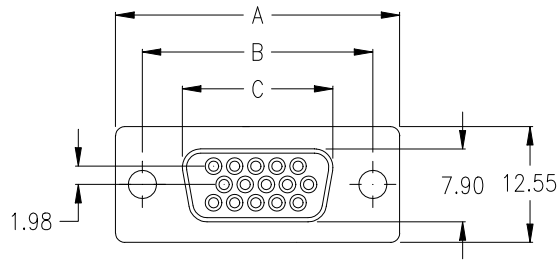

Ordering Code

SHF - xxx - S111 - 95 / XXX

No. of contacts

Option

Plating: -95 = tin(leadfree)/gold  
General Specification page 72

No. of contacts	Dimension		
	A	B	C
015	30.81	24.99	16.33
	1.213	.984	.643
026	39.14	33.32	24.66
	1.541	1.312	.971
044	53.04	47.04	38.38
	2.088	1.852	1.511
062	69.32	63.50	54.84
	2.729	2.500	2.159

Options

Special product.  
Please ask for availability and minimum order quantity before you consider the article for development, design in or production purposes.

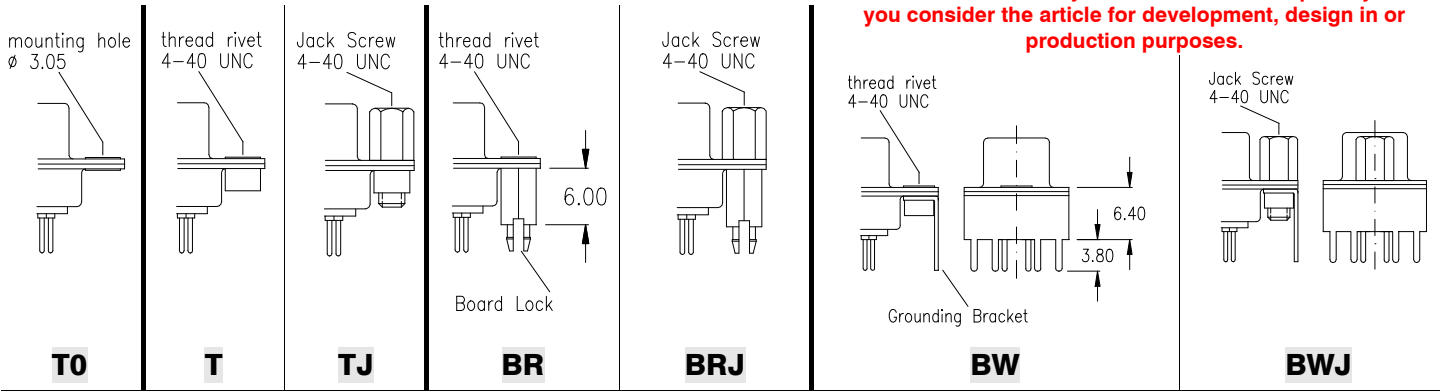

PCB Layout „female“

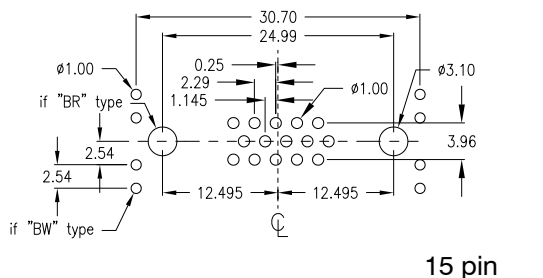

15 pin

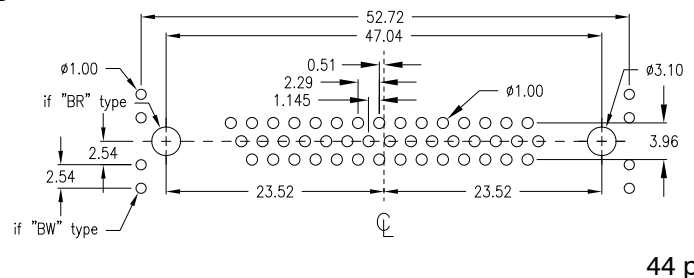

44 pin

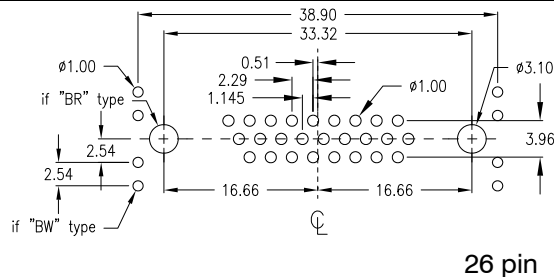

26 pin

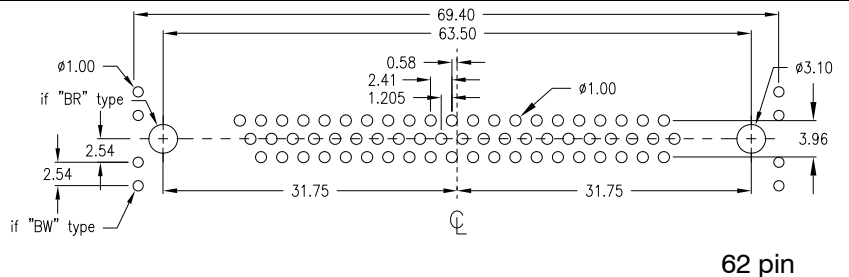

62 pin