

REV.	DESCRIPTION	DATE	DRAWN
A	NEW	02.09.2014	RH

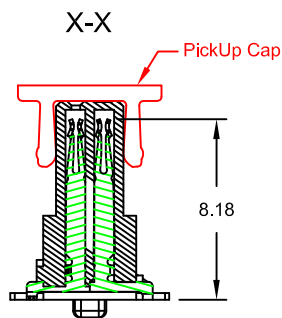
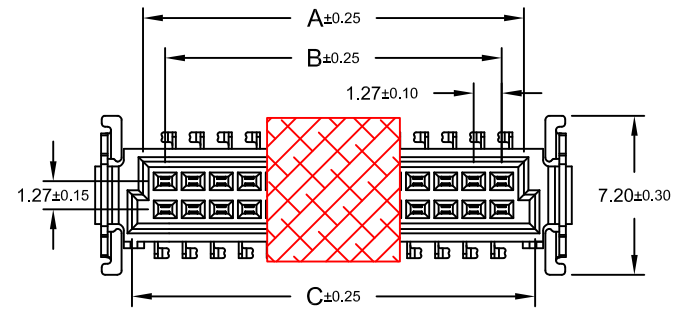

**Order Code**  
MBC-xxx-BFV90-xx/11X

**Packing Options**

- C = tube
- D = tube and PickUp Cap
- E = reel and PickUp Cap

**Plating**

- 96 = tin / gold 5μ" (standard)
- Options:
- M95 = matte tin / gold flash
- 57 = gold flash / gold 10μ"

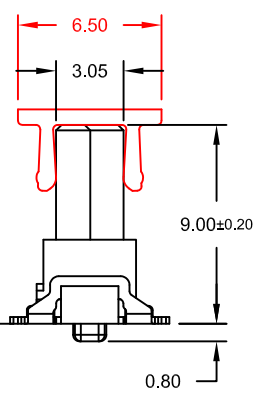
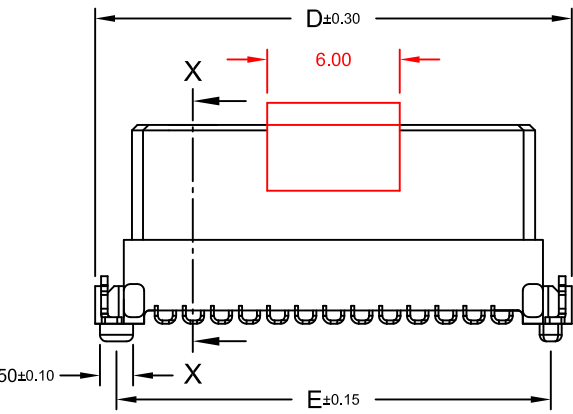

$\square$	<50Pin = 0.12
$\square$	>50Pin = 0.15

No. of Contact	Dimension mm				
	A	B	C	D	E
012	8,37	6,35	9,37	13,20	10,77
026	17,26	15,24	18,26	22,09	19,66
050	32,50	30,48	33,50	37,33	34,90
060	38,85	36,83	39,85	43,68	41,25
068	43,93	41,91	44,93	48,76	46,33
080	51,55	49,53	52,55	56,38	53,95

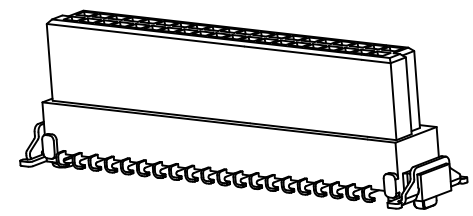

**Materials**

Contact: Copper Alloy  
 Plating: Gold, Tin or Duplex  
 \*Duplex = Gold plated on contact area, Tin on solder area  
 Insulator: LCP UL 94V-0 (Black)  
 Lifetime: >500 mating cycles  
 Operating temperature: -55°C to +125°C  
 Processing temperature: +260°C ca. 10 sec.

**Specifications Electrical**

Current rating per contact: min. 1.1A @20°C  
 Insulation resistance: 10.000MΩ min.  
 Withstanding voltage: 500V AC  
 Contact resistance: 30mΩ max.

**Recommended PCB Layout Top View**  
(Tolerance ±0.05)

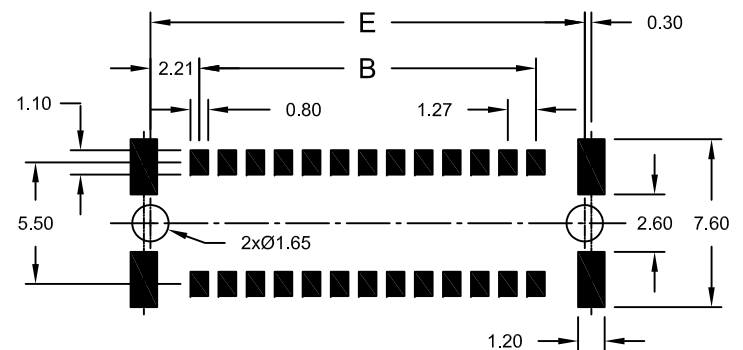

UNIT mm	GENERAL TOLERANCE		DRAWN RH	DATE 02.09.2014	DWG. NO. MBC-BFV90/11	SHEET 1/1	
	SCALE Free	X° ±					X. ± 0.30
		.X° ±					.X ± 0.25
		.XX° ±					.XX ± 0.15
.XXX° ±		.XXX ± 0.10					
	CHECK Hogi	DATE 02.09.2014	APPROVE Hogi	DATE 02.09.2014	SERIES NO. MBC-xxx-BFV90-xx/11X	REV. A	

**Multi BUS/Backplane Connector**  
**B-Type Female SMT vertical**  
 1.27mm pitch height - 9,00mm  
*compatible to ERNI INTERact® Series SMC Type*