

“low profile“ Sockets & Strips

**Low profile DIP sockets LOP Series**

height above PCB 2.41mm / .095"

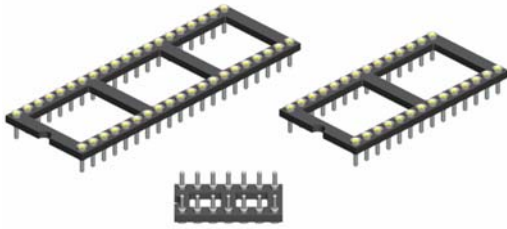

**Low profile strips SLP Series**

height above PCB 2.41mm / .095"

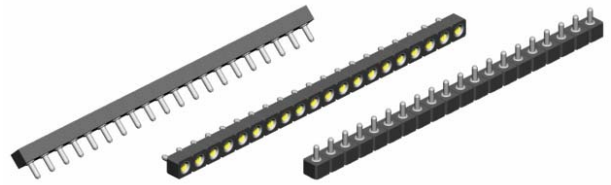

**Insulator**

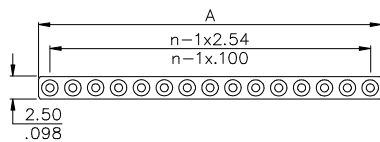
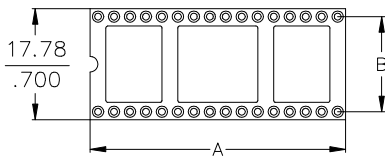
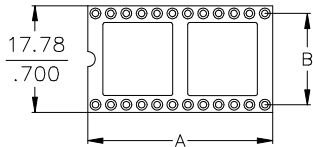
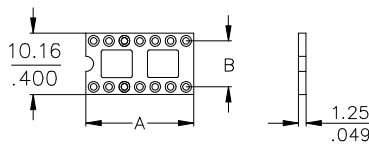

| Pin | Dimensions mm/inch |               | Ordering Code                |
|-----|--------------------|---------------|------------------------------|
|     | "A"                | "B"           |                              |
| 14  | 17,78/.700         | 7,62<br>.300  | <b>LOP - 314 - S083 - 95</b> |
| 16  | 20,32/.800         |               | <b>LOP - 316 - S083 - 95</b> |
| 18  | 22,86/.900         |               | <b>LOP - 318 - S083 - 95</b> |
| 20  | 25,40/1.000        |               | <b>LOP - 320 - S083 - 95</b> |
| 24  | 30,48/1.200        |               | <b>LOP - 324 - S083 - 95</b> |
|     |                    | 15,24<br>.600 |                              |
| 24  | 30,48/1.200        |               | <b>LOP - 624 - S083 - 95</b> |
| 28  | 35,56/1.400        |               | <b>LOP - 628 - S083 - 95</b> |
|     |                    | 15,24<br>.600 |                              |
| 32  | 40,64/1.600        |               | <b>LOP - 632 - S083 - 95</b> |
| 40  | 50,80/2.000        |               | <b>LOP - 640 - S083 - 95</b> |
|     |                    |               |                              |
| 10  | 25,40/1.000        |               | <b>SLP - 110 - S083 - 95</b> |
| 14  | 35,56/1.400        |               | <b>SLP - 114 - S083 - 95</b> |

**Other sizes and flush head version on request**

**Pin-outs**

*Other pin-outs available on request.*

Despite the very low profile of these sockets the IC legs can be inserted completely.

**Recommended PCB Layout**

*Recommended drilling hole dia Ø 0,8mm/.031"*

**Low Profile Terminal**

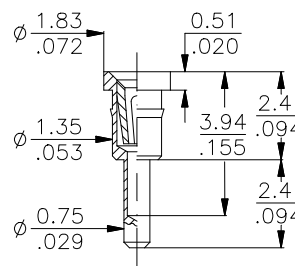

**083** 2.41mm / .095" over PCB

**Plating**

**Standard:**

- **95** = tin/gold  
*(tin leadfree)*

**Alternative**

- **55** = gold/gold  
- **99** = tin/ tin  
*(leadfree)*

**Specifications**

**Mechanical data**

Insertion force 1,80 N (avg)  
Extraction force 0,90 N (avg)  
Contact life > 100 cycles  
Solderability as per IEC 60068-2-58  
Contact security:  
-Vibration as per EN60352-4  
-Shock as per EN60352-4

**Material**

Insulator *(RoHS compliant)* PBT UL 94 V-0  
Terminal *(RoHS compliant)* CuZn  
Contact *(RoHS compliant)* BeCu

**Electrical data**

Contact resistance at 1A 4,3 mΩ typ.  
Current rating 1A max., 100V  
Contact capacitance at 1MHz 2 pF max.  
Insulation resistance at 500V DC 5 × 10<sup>9</sup> Ω min.  
Breakdown voltage at 60 Hz 500 V AC  
Contact resistance ≤ 7 mΩ

**Operating temperature**

-55° C to +125° C

**Pitch**

2,54 mm (.100")

**More information, for example about testresult please ref. to page 49 or contact E-tec.**